

Key Features & Benefits:

- The KNX-RPP Provides Wireless 0-10V Dimming and On/off Switch Control Within ESL Vision's Konex Technology
 - Real-time Energy Monitoring
 - Easily Group with Konex Fixtures and Sensors Within ESL Vision's Lighting App*
 - Control up to 600W with a Single KNX-RPP
 - 12v Aux Power Output
- * Look for the ESL Vision APP on the Google Play Store.

Project: _____ Date: _____

Catalog #: _____

Notes: _____



Technical Specifications:

INPUT SPECIFICATIONS	
Input Voltage	120-277 VAC
Voltage Range	108-305 VAC
Input Frequency	50/60 HZ
Input Power	600W Max
Input Current	2.6A Max
Inrush Current	≤20A

OUTPUT SPECIFICATIONS	
Output Current	2A Max
Ripple Voltage	240MV
Standby Power	≤1.5W
Aux Output	100mA Max
Protections	Short Circuit, Open Circuit, Over Current, Over Temperature, Over Voltage

GENERAL INFORMATION	
Dimming Type	0-10V
Dimming Range	0%-100%
Warranty	5 Years

ENVIRONMENTAL SAFETY & EMC	
Operating Temperature	14°F~122°F (-10°C~50°C)
UL Standards	UL8750
FCC	2AUVL-RPP-001
EMC Compliance	EN55032/FCC PART15

Dimensions:

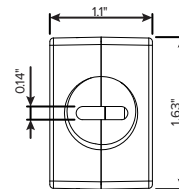
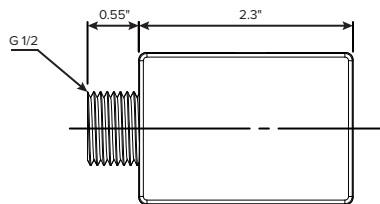

Ordering Guide:

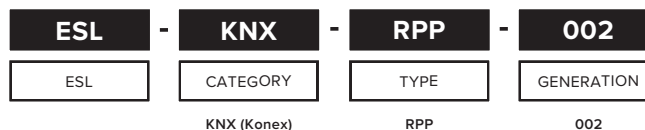

Konex Technology:

The ESL Vision KNX-RPP allows the end user to integrate wireless controls to new or existing lighting. Combining dimming and occupancy capabilities and controlling one fixture or grouping is effortless with Konex by ESL Vision.

- Upgrade an existing fixture with wireless technology
- Create dimmable options
- Control specific locations with a KNX wireless switch

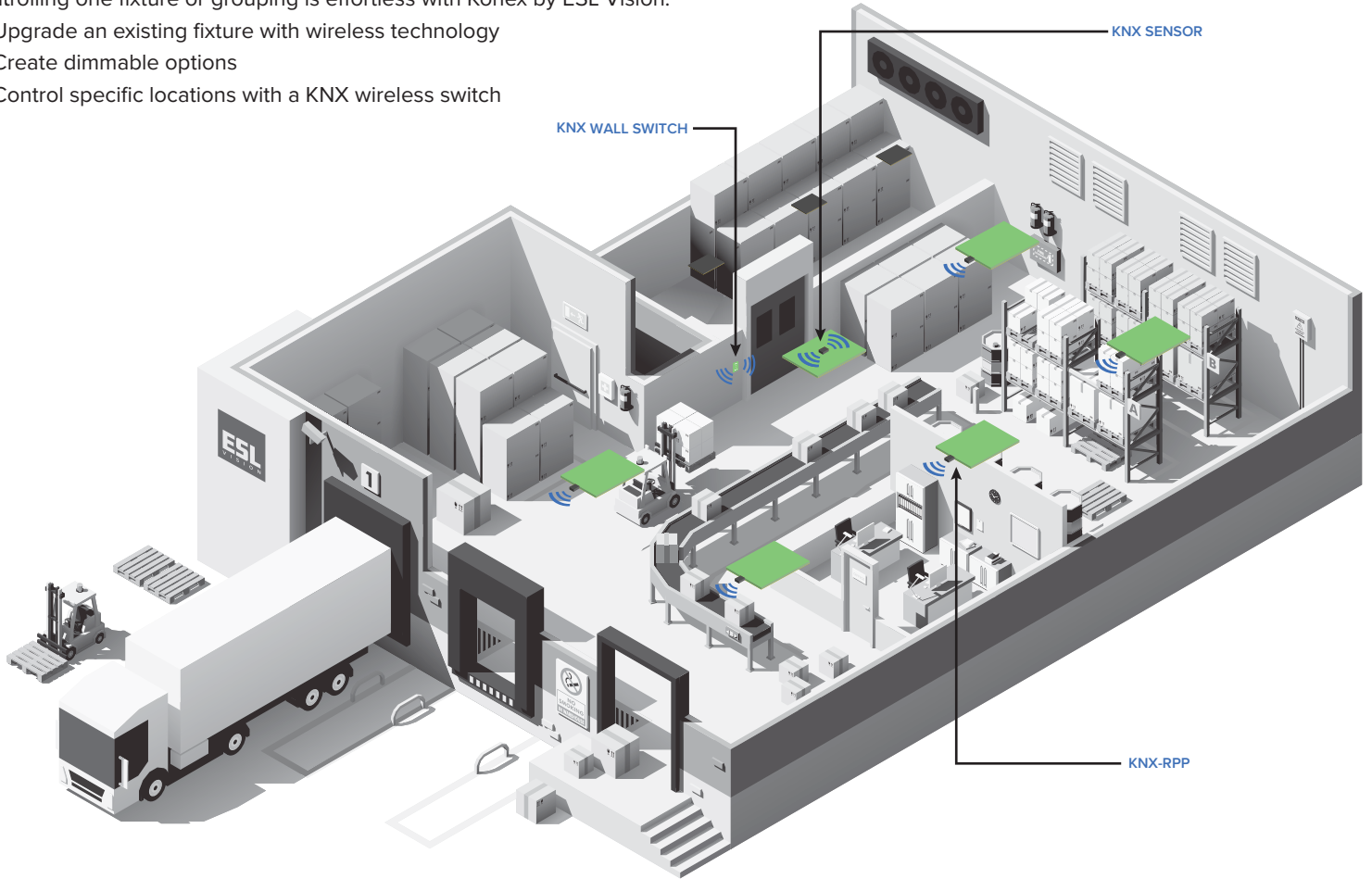

Installation:

