

Tools Needed

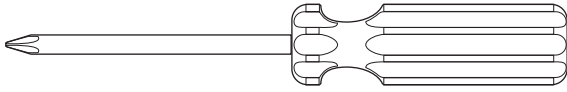

Phillips Screwdriver

Dimensions

ESL-ACCS-22-FLK-01

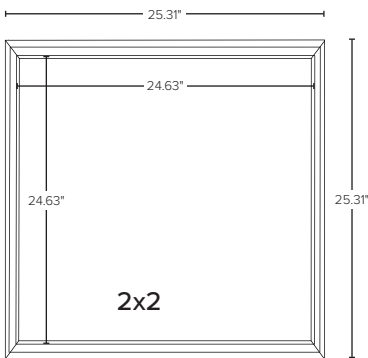

ESL-ACCS-14-FLK-01

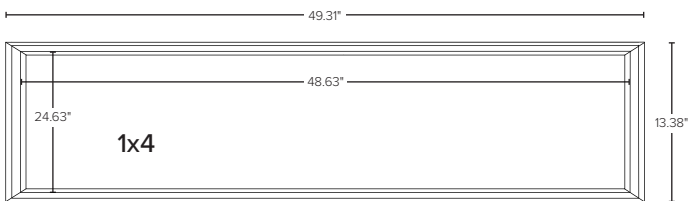

ESL-ACCS-24-FLK-01

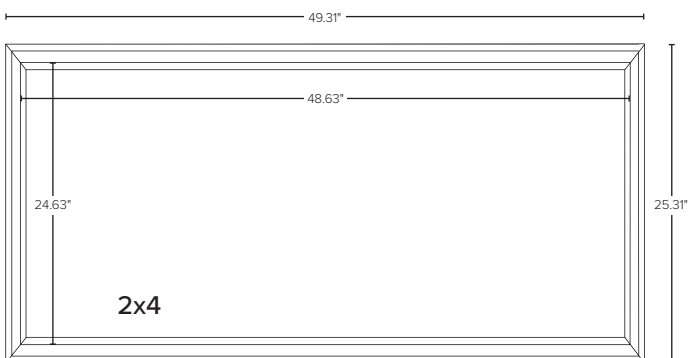

Installation

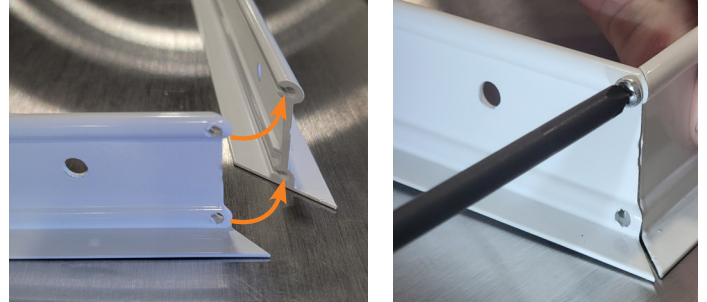

1 Using 2 screws for each corner, screw the frame together with a Phillips screwdriver.



2 Attach the frame to studs/joists in the ceiling through the holes in the sides.

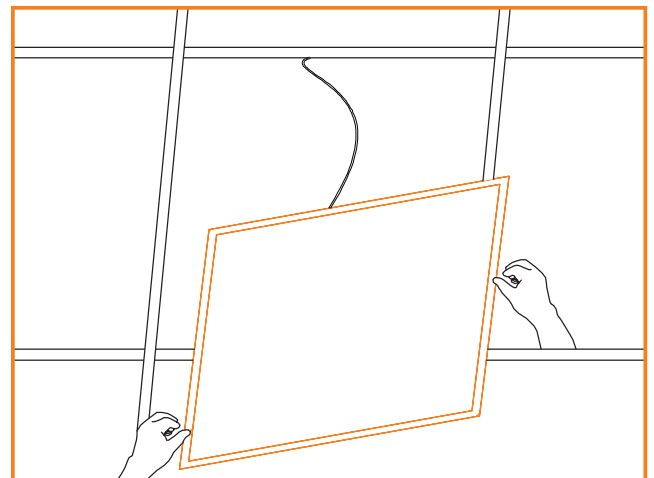

3 Angle the fixture to fit up into the ceiling and then drop in place.