



LED 8' STRIP SERIES



Ti - WBS8 - 36 Watts

PAGE 1 OF 3

Key Features & Benefits:

- Housing:
 - Strip fixture dimensions (96" x 4.25" x 3.75")
 - Die-formed and embossed code 22 gauge steel
 - Finish is high reflectance baked white enamel
- Gear Trey:
 - Flat heavy gauge die-formed code grade steel for all components
 - Ti mounting for 1 and 2 Ti bar locations
 - Easy Access for quick installation
- Long Life:
 - 10 year warranty (12 hour run times)
 - 7 year warranty (24 hour run times)
- 0-10v Dimming Available in Specific Models
- Control Options:
 - Photocell
 - Occupancy
- Emergency Capable
- 3/4" Knockouts on Both Ends



Project: _____

Date: _____

Catalog #: _____

Notes: _____



Electrical Data:

Light Specifications:

Lumen Output: Up to 4,975 Lumens
 Efficacy (lm/W): Up to 143 Lumens per Watt
 Kelvin: 3000K, 3500K, 4000K, 5000K
 Color Rendering Index (CRI): >82
 Rated Life: > 80,000 hrs

Driver Data:

Input Voltage: 120-277 VAC
 Input Power: 36W
 Input Current @ 120V: 0.3 Amps
 Input Current @ 240V: 0.15 Amps
 Input Current @ 277V: 0.13 Amps
 Total Harmonic Distortion (THD): <10%
 Power Factor: >0.99
 Operating Temperature: -4 ~ 122°F

Catalog Data:

| ITEM# | WATTS | LUMEN OUTPUT | EFFICACY (lm/W) | KELVIN |
|-----------------------|-------|--------------|-----------------|--------|
| ESL-Ti-WBS8-S-36W-F30 | 36W | 4,861 | 139 | 3000K |
| ESL-Ti-WBS8-S-36W-F35 | 36W | 4,843 | 139 | 3500K |
| ESL-Ti-WBS8-S-36W-F40 | 36W | 4,918 | 141 | 4000K |
| ESL-Ti-WBS8-S-36W-F50 | 36W | 4,975 | 143 | 5000K |

* Made in the USA option available upon request



LED 8' STRIP SERIES



Technical Specifications

Ordering Guide:

| | | | | | | | | | | | | | | |
|------------|---|-----------|---|-------------|---|----------|---|--|---|-------------|---|--|---|----------------|
| ESL | - | Ti | - | WBS8 | - | S | - | 36W | - | F | - | S | - | Options |
| ESL | | TYPE | | SERIES | | LISTING | | WATTS | | LENS | | KELVIN | | OPTIONS |
| | | Ti Series | | WBS8 | | S | | 26W (26 Watts) 30W (30 Watts) 36W (36 Watts) 44W (44 Watts) | | F (Frosted) | | 30 (3000 Kelvin) 35 (3500 Kelvin) 40 (4000 Kelvin) 50 (5000 Kelvin) | | |

Example Part Number: ESL-Ti-WBS8-S-36W-F30

Options (Add as Suffix):

- **Emergency:**
 - EMG-FDC-9.5W (Emergency Back-up, 1,100 lumens, 90 min)
 - **Sensors:**
 - ESL-1OCC (External Occupancy Sensor)
 - ESL-4OCC (Microwave Occupancy Sensor)
 - ESL-4OPH (Photocell)
 - ESL-4OCP (Photocell & Microwave Occupancy Sensor)
 - **Cord Sets:***
 - ESL-CS3W-6 (Cord Set, White, 3 wire, 6 foot)
 - ESL-CS3W-6P (Cord Set, White, 3 wire, 6 foot, Standard Plug)
 - ESL-CS3W-12 (Cord Set, White, 3 wire, 12 foot)
 - ESL-CS3W-12P (Cord Set, White, 3 wire, 12 foot, Standard Plug)
 - **Wire Guards:**
 - ESL-WBS-WG01 (Wire Guard Body Strip Fixture)
 - **Whips: Flexible Conduit:**
 - ESL-WP3-6 (Whip, 3 wire, 6 foot)
 - ESL-WP3-12 (Whip, 3 wire, 12 foot)
 - **Mounting:**
 - ESL-VH01 (V-Hangers sets)
 - ESL-JC01 (Jack Chain - per foot)
 - ESL-HB-PM01 (Pendant Mounting)
 - **Miscellaneous:**
 - ESL-SPD-277-1 (Surge Protector; 100-277V)
 - ESL-480V-SD01 (480 Volt Step Down Transformer)
- *Other lengths and black cord available upon request

Dimensions:

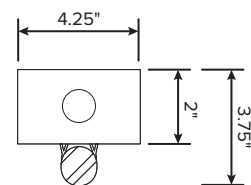
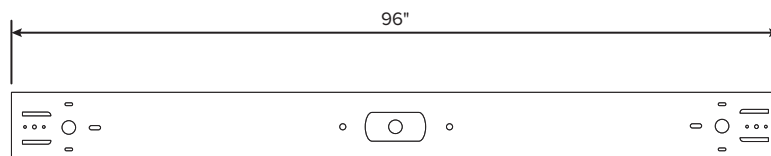

2' - STRIP SERIES



| NARROW SINGLE LAMP BODY | SERIES | PART NUMBER | WATTS | (lm/W)* | LUMEN OUTPUT* |
|------------------------------|-----------------------|-----------------------|-------|---------|---------------|
| | TI NBS2 | ESL-Ti-NBS2-S-10W-FXX | 10 | 133 | 1,330 |
| TI NBS2 | ESL-Ti-NBS2-S-13W-FXX | 13 | 133 | 1,729 | |
| — WIDE — SINGLE LAMP BODY | SERIES | PART NUMBER | WATTS | (lm/W)* | LUMEN OUTPUT* |
| | TI WBS2 | ESL-Ti-WBS2-S-10W-FXX | 10 | 133 | 1,330 |
| TI WBS2 | ESL-Ti-WBS2-S-13W-FXX | 13 | 133 | 1,729 | |
| — WIDE — TWO LAMP BODY | SERIES | PART NUMBER | WATTS | (lm/W)* | LUMEN OUTPUT* |
| | TI WBS2 | ESL-Ti-WBS2-S-20W-FXX | 20 | 133 | 2,660 |
| TI WBS2 | ESL-Ti-WBS2-S-26W-FXX | 26 | 133 | 3,458 | |

4' - STRIP SERIES



| NARROW SINGLE LAMP BODY | SERIES | PART NUMBER | WATTS | (lm/W)* | LUMEN OUTPUT* |
|------------------------------|-----------|-------------------------|-------|---------|---------------|
| | TI NBS4 | ESL-Ti-NBS4-S-13W-FXX | 13 | 133 | 1,729 |
| | TI NBS4 | ESL-Ti-NBS4-S-15W-FXX | 15 | 133 | 1,995 |
| | TI NBS4 | ESL-Ti-NBS4-S-18W-FXX | 18 | 133 | 2,394 |
| | TI NBS4 | ESL-Ti-NBS4-S-22W-FXX | 22 | 133 | 2,926 |
| | TiHO NBS4 | ESL-TiHO-NBS4-S-30W-FYY | 30 | 126 | 3,780 |
| — WIDE — SINGLE LAMP BODY | SERIES | PART NUMBER | WATTS | (lm/W)* | LUMEN OUTPUT* |
| | TI WBS4 | ESL-Ti-WBS4-S-13W-FXX | 13 | 146 | 1,818 |
| | TI WBS4 | ESL-Ti-WBS4-S-15W-FXX | 15 | 143 | 2,101 |
| | TI WBS4 | ESL-Ti-WBS4-S-18W-FXX | 18 | 143 | 2,473 |
| | TI WBS4 | ESL-Ti-WBS4-S-22W-FXX | 22 | 138 | 2,862 |
| | TiHO WBS4 | ESL-TiHO-WBS4-S-30W-FYY | 30 | 144 | 4,089 |
| — WIDE — TWO LAMP BODY | SERIES | PART NUMBER | WATTS | (lm/W)* | LUMEN OUTPUT* |
| | TI WBS4 | ESL-Ti-WBS4-S-26W-FXX | 26 | 144 | 3,587 |
| | TI WBS4 | ESL-Ti-WBS4-S-30W-FXX | 30 | 139 | 3,939 |
| | TI WBS4 | ESL-Ti-WBS4-S-36W-FXX | 36 | 139 | 4,746 |
| | TI WBS4 | ESL-Ti-WBS4-S-44W-FXX | 44 | 134 | 5,793 |
| | TiHO WBS4 | ESL-TiHO-WBS4-S-60W-FYY | 60 | 140 | 8,522 |

8' - STRIP SERIES



| — WIDE — TWO LAMP BODY | SERIES | PART NUMBER | WATTS | (lm/W)* | LUMEN OUTPUT* |
|---------------------------|-----------|--------------------------|-------|---------|---------------|
| | TI WBS8 | ESL-Ti-WBS8-S-26W-FXX | 26 | 146 | 3,528 |
| | TI WBS8 | ESL-Ti-WBS8-S-30W-FXX | 30 | 143 | 4,031 |
| | TI WBS8 | ESL-Ti-WBS8-S-36W-FXX | 36 | 143 | 4,975 |
| | TI WBS8 | ESL-Ti-WBS8-S-44W-FXX | 44 | 140 | 5,944 |
| | TiHO WBS8 | ESL-TiHO-WBS8-S-60W-FYY | 60 | 144 | 8,538 |
| — WIDE — TWO LAMP BODY | SERIES | PART NUMBER | WATTS | (lm/W)* | LUMEN OUTPUT* |
| | TI WBS8 | ESL-Ti-WBS8-S-52W-FXX | 52 | 144 | 6,898 |
| | TI WBS8 | ESL-Ti-WBS8-S-60W-FXX | 60 | 139 | 8,559 |
| | TI WBS8 | ESL-Ti-WBS8-S-72W-FXX | 72 | 139 | 9,701 |
| | TI WBS8 | ESL-Ti-WBS8-S-88W-FXX | 88 | 134 | 11,690 |
| | TiHO WBS8 | ESL-TiHO-WBS8-S-120W-FYY | 120 | 140 | 17,154 |

* At 5000K. See spec sheets for other kelvins
 XX = 30, 35, 40, or 50 for kelvin temperature
 YY = 40 or 50 for kelvin temperature