

Key Features & Benefits:

- Modern Brushed Nickel Design
- Impact Resistant UV Protected White Polycarbonate Housing
- Wet Rated for Outdoor Applications

Project: _____

Date: _____

Catalog #: _____

Notes: _____



Technical Specifications:

Power: 9 Watts
 Lumen Output: Up to 800 Lumens
 Efficacy (lm/W): Up to 95 Lumens per Watt
 Kelvin: 3000K, 4000K, 5000K
 CRI: >80
 Input Voltage: 120 VAC
 Life Span: 50,000 Hours
 Ingress: IP65
 Dimensions(LxWxD)*: 9" x 10.75" x 3.5" (Heads extended straight out)

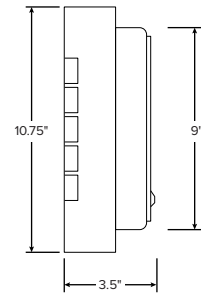
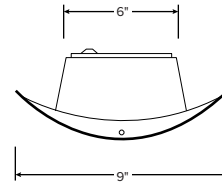

Catalog Data:

ITEM#	WATTS	LUMEN OUTPUT	EFFICACY (lm/W)	KELVIN
ESL-NP-SC-EBN-3	9W	800	95	3000K
ESL-NP-SC-EBN-4	9W	800	95	4000K
ESL-NP-SC-EBN-5	9W	800	95	5000K

Ordering Guide:

Example Part Number: **ESL-NP-SC-EBN-3**

ESL	-	NP	-	SC	-	E	BN	-	
ESL		TYPE		GROUP		BASE	FINISH		KELVIN
		NP		SC (Sconce)		E (E26)	BN (Brush Knickle)		3 (3000K) 4 (4000K) 5 (5000K)