

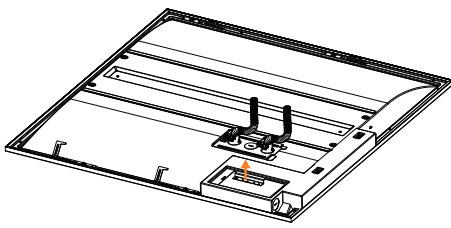

⚠ WARNING

1. To avoid electric shock, disconnect power at source prior to installation.
2. The installation should be performed by qualified electricians or lighting technicians.
3. Before conducting any installation, maintenance, or removal, disable all power.
4. Do not touch the fixture while it is in service.
5. If there is any problem with the fixture, turn off power and **DO NOT** attempt repair unless you are a qualified technician or the customer service member.

Installation



1 Remove driver covers and connect conduit to driver box.

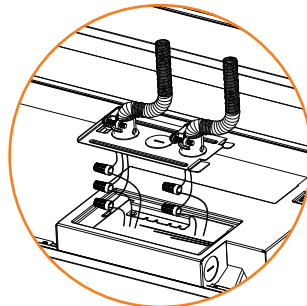

2 Connect coordinating wires, secure driver covers to fixture.

Wiring Diagram

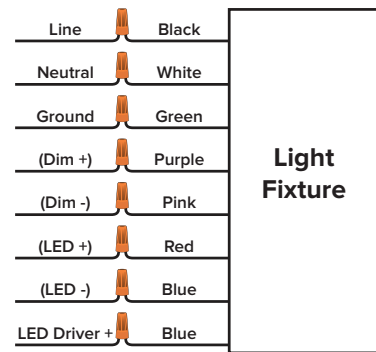

Recessed Installation

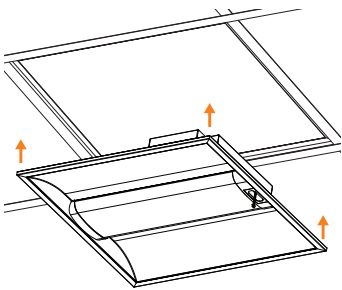

1 Install the fixture into the ceiling T-grid system. Ensure that it has a snug fit, and that all of the fixtures in a given area are oriented in the same direction.

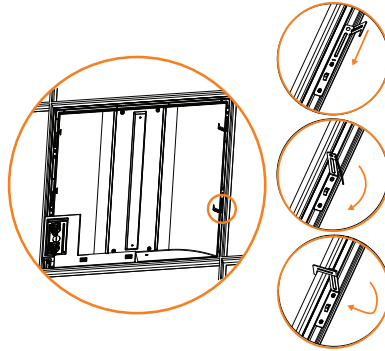

2 Use protective brackets for safe installation in the ceiling frame.

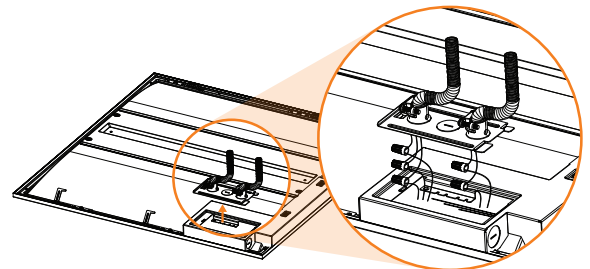

3 Remove electrical access plate and the necessary knockouts. Use conduit connectors to attach the electrical supply cable to the access plate. Connect wires as shown in the Wiring Diagram. Push wires back into the box and re-attach the access plate.

Sensor Installation

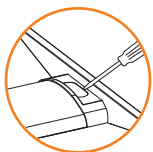

Fig. 1

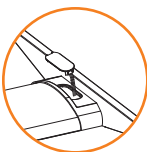

Fig. 2

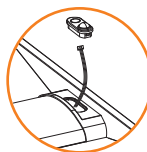

Fig. 3

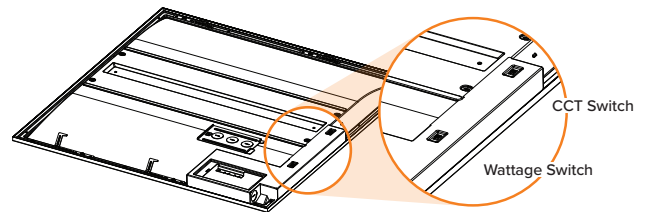

Fig. 4

An approved sensor may be installed before or after fixture installation.

1. Remove the sensor plate.
2. Remove the flat cable from the back of the plate.
3. Insert the cable terminals into the approved sensor.
4. Snap the sensor into the fixture securely.

CCT & Wattage Adjustment



1 Kelvin and wattage can be adjusted using the dip switches located on the driver.

2 Select the desired kelvin and wattage by adjusting the dip switch.

