

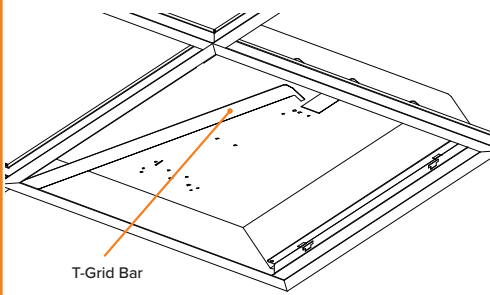

⚠ WARNING

1. To avoid electric shock, disconnect power at source prior to installation.
2. The installation should be performed by qualified electricians or lighting technicians.
3. Before conducting any installation, maintenance, or removal, disable all power.
4. Do not touch the fixture while it is in service.
5. If there is any problem with the fixture, turn off power and **DO NOT** attempt repair unless you are a qualified technician or the customer service member.

Retrofit Installation



1 Disconnect power, then remove existing hardware. Leave supply and grounding leads. Ballast may need to be removed.

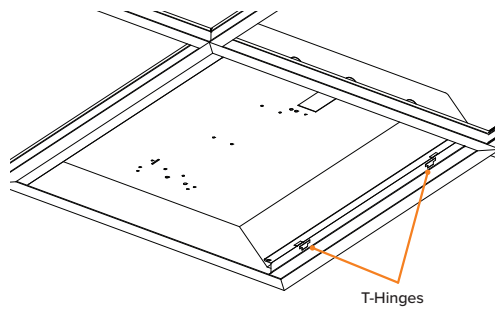

2 Lift the original fixture housing and slide into both side brackets between the housing and the T-grid. Lower the housing to rest on the brackets, securing them in place. Attach safety cables to the original fixture housing using the provided buckle.

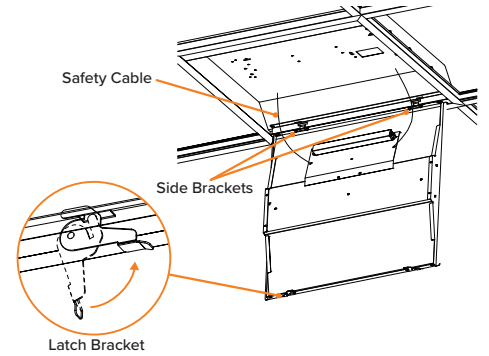

3 Connect the retrofit fixture to AC power. Wire the existing fixtures ground wire to the retrofit fixtures ground wire. Secure housing by locking both of the latch brackets into T-Grid slots.

CCT & Wattage Adjustment

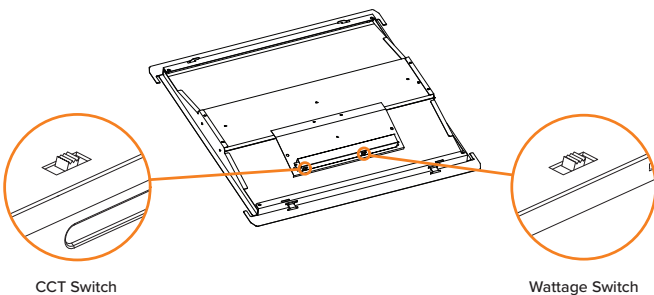

1 Kelvin and wattage can be adjusted using the dip switches located on the driver.

2 Select the desired kelvin and wattage by adjusting the dip switch.

Sensor Installation

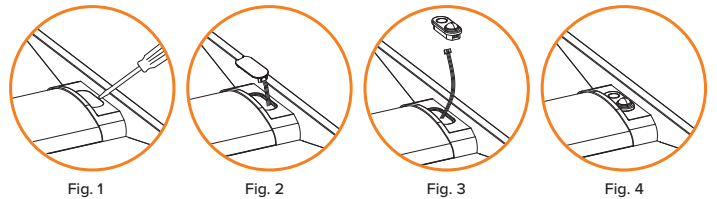

An approved sensor may be installed before or after fixture installation.

1. Remove the sensor plate.
2. Remove the flat cable from the back of the plate.
3. Insert the cable terminals into the approved sensor.
4. Snap the sensor into the fixture securely.

Wiring Diagram

